

Ease of operation

Taking only minutes to set up, the Sedgwick TE/TESH is easy to use and accurate in operation. Work is positioned on the rolling table against an end stop and a fence, and is secured by a cam action clamp. Its end is then passed between two vertically mounted cutterheads which machine the top and bottom cheeks of the tenon. The tenon width is set by raising or lowering the top motor, and its position on the timber by raising/lowering the two motors in tandem. Variations in shoulder length are set using the rule on the end stop, and staggered tenons are achieved by simple handwheel adjustment of the top motor, again reading from a rule.

Versatility

Each cutting head has provision for profile knives to enable the operator to match the cross section of the components being jointed. Alternatively the optional scribing head provides improved accuracy, ease of setting, and finish. Stepped tenons, splayed tenons, scribed tenons, double tenons, and multiple bridles are all possible on this versatile machine. Combinations of 90 degree and bevelled cutting discs with appropriate spacers can also be fitted to produce interleaved joints as used in sash window construction.

Construction

The Sedgwick TE/TESH is designed and built to withstand continuous production use. Its cast iron base, column and slideways provide a rigid and durable mainframe assembly, and the 2.2Kw motors supply ample power. The generously proportioned cast iron sliding table is mounted on bearing equipped hardened steel rollers for minimum wear, and cutterhead slide movements are easily adjusted on dovetail slides for ease of maintenance.

Safety Features

The TE/TESH offers all of these safety features as standard:

- Automatic braking
- Starters with thermal overload, no volt release protection and lock off emergency stop switch.
- High performance lightweight cutter blocks with chip limiting devices
- Large diameter dust extraction outlets
- One piece front cutter guard



Single Ended Tenoners

Models TE/TESH

Specification	
MOTOR RATING	2 x 2.2kw
TIMBER CAPACITY	130mm x 310mm
TIMBER CAPACITY WITH FENCE AT 45 DEG.	130mm x 195mm
MAXIMUM LENGTH OF TENON	155mm
MAX. LENGTH OF TENON - 2 PASSES	205mm
VERTICAL ADJUSTMENT OF BOTTOM CUTTER BLOCK	0 TO 60mm
VERTICAL ADJUSTMENT OF TOP CUTTER BLOCK	0 TO 120mm
HORIZONTAL ADJUSTMENT OF TOP CUTTER BLOCK	±32mm
TABLE SIZE	800mm x 310mm
TABLE WORKING HEIGHT	860mm
MAIN CUTTER HEADS*	2 x 175 x 60mm
*Each with 4 shear cut replaceable knives and 2 spur cutters. Provision for 2 scribing cutters and chip limiters is provided in both the top and the bottom heads.	
EXTRACTION OUTLETS	2x 150mm (REQ.2800cmh)
OPTIONAL SCRIBING HEAD	
MOTOR RATING	3ph 4.0Kw (5.5hp) 1ph 2.2Kw (3hp)
CUTTER BLOCK	Optional
SHAFT DIAMETER	30mm (end-tapped M12; 8mm keyway)
EFFECTIVE LENGTH OF SHAFT	75mm
VERTICAL MOVEMENT	95mm
HORIZONTAL MOVEMENT	30mm
MAXIMUM DIAMETER OF TOOLING	210mm
SHIPPING DETAILS	
DIMENSIONS - L x W x H	1220 x 920 x 1350mm
NETT WEIGHT	TE : 300kg TESH : 350kg

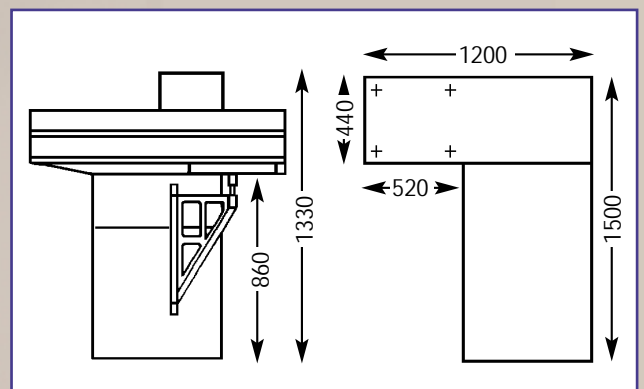

Specifications and dimensions are subject to change and do not form part of a contract.